



Installation Instruction - Electrical

Applicable for G502

Contents

1	General	2
2	Go/No Go Testing	2
2.1	Test Set-up Go/No Go test	2
2.2	Test Set	3
2.3	RF Connections Antenna Coupler	3
2.4	RF Connections Antenna adapter (optional)	3
3	Calibration	4
3.1	Test set up – SERP (only authorized centers)	4
3.2	Test Set	4
3.3	Power Supply	5
3.4	Battery eliminator	5
3.5	GPIO card and cable	5
3.6	RF Connection	5
3.7	SonyEricsson programming interface – SEPI	5
3.8	Sony Ericsson programming interface cable	5
3.9	USB PC cable	5
4	General Equipment	6
4.1	Test Set up	6
4.2	Computer	6
4.3	Service Card Reader and Service Card	6
4.4	SonyEricsson programming interface – DCU-65	7
4.5	Label Printer (optional)	7
4.6	Bluetooth Device	7
5	Software	7
5.1	EMMA	7
5.2	Labelmake II software (optional)	7
5.2.1	Willtek 420x Go/No-Go Test Script	8
5.2.2	SERP Go/No Go Test Script	8
5.3	SERP (only authorized centers)	8
6	Revision History	9

1 General

The Electrical Installation Instructions describes the procedures for installing all of the hardware and software needed to perform testing, calibration, software loading and repair activities at an Electrical level for the Sony Ericsson products specified.

2 Go/No Go Testing

There are two options for performing a Go No/Go test. One is to use an RF Fixture and the other is to use an antenna coupler together with a shielding box.

2.1 Test Set-up Go/No Go test

All test hardware necessary for this test set up is documented in the Electrical Equipment List.

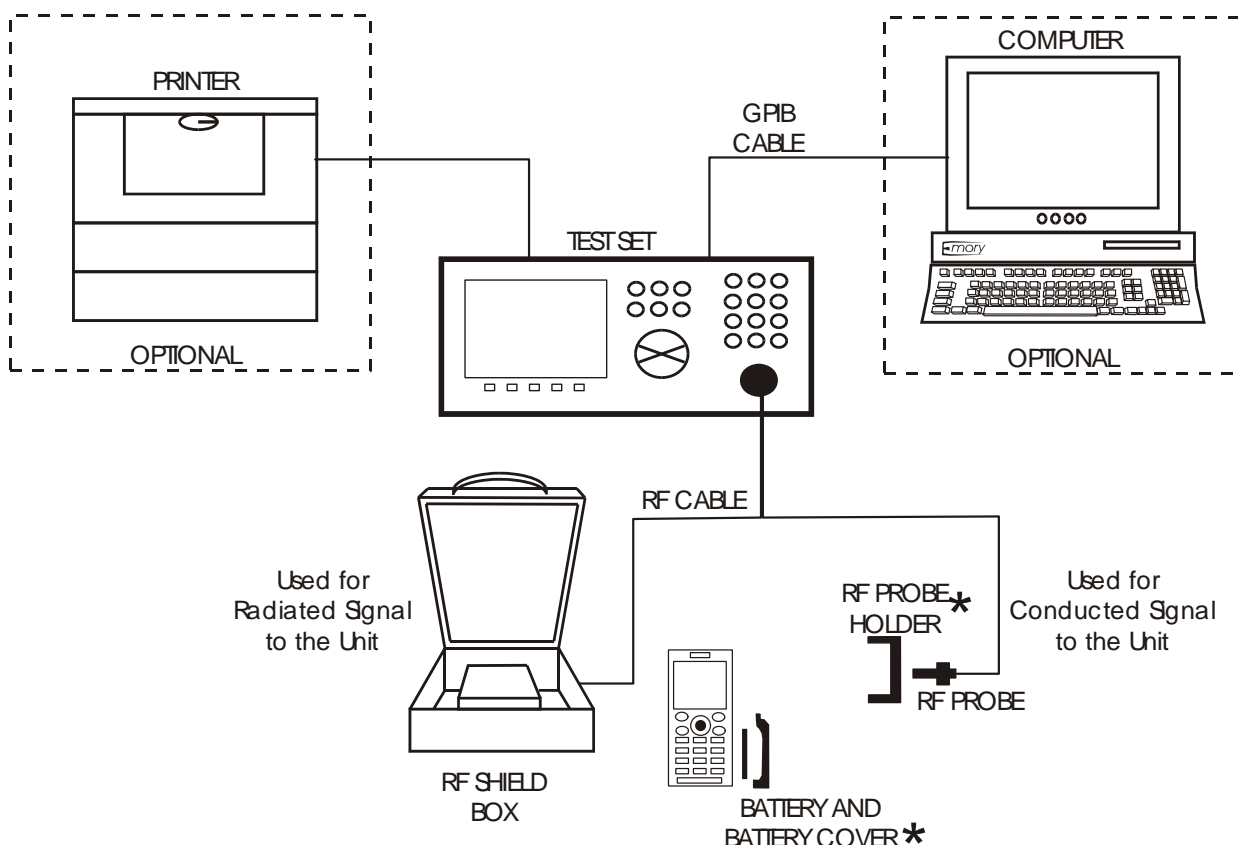

* The RF Probe Holder and the Battery Cover may not be used for every product. See the Installation Instructions and Test Instructions for details.

2.2 Test Set

An E-GSM 900/GSM 1800/GSM 1900 Test Set approved according to the Instrument List must be used.

It should be installed according to the Instrument Manufacturer Instructions.

2.3 RF Connections Antenna Coupler

Connect the RF Cable between the RF-port of the Test set and the RF Shield box. The Antenna Coupler should be installed into the RF Shield Box according to manufacturer instructions.

2.4 RF Connections Antenna adapter (optional)

Connect the RF-cable between the RF-port of the Test set and the Antenna adapter. Assemble the RF adapter to the RF-holder according to the information in the Test Instruction Electrical.

3 Calibration

3.1 Test set up – SERP (only authorized centers)

All test hardware necessary for this test set up is documented in the Electrical Equipment and Instrument List.

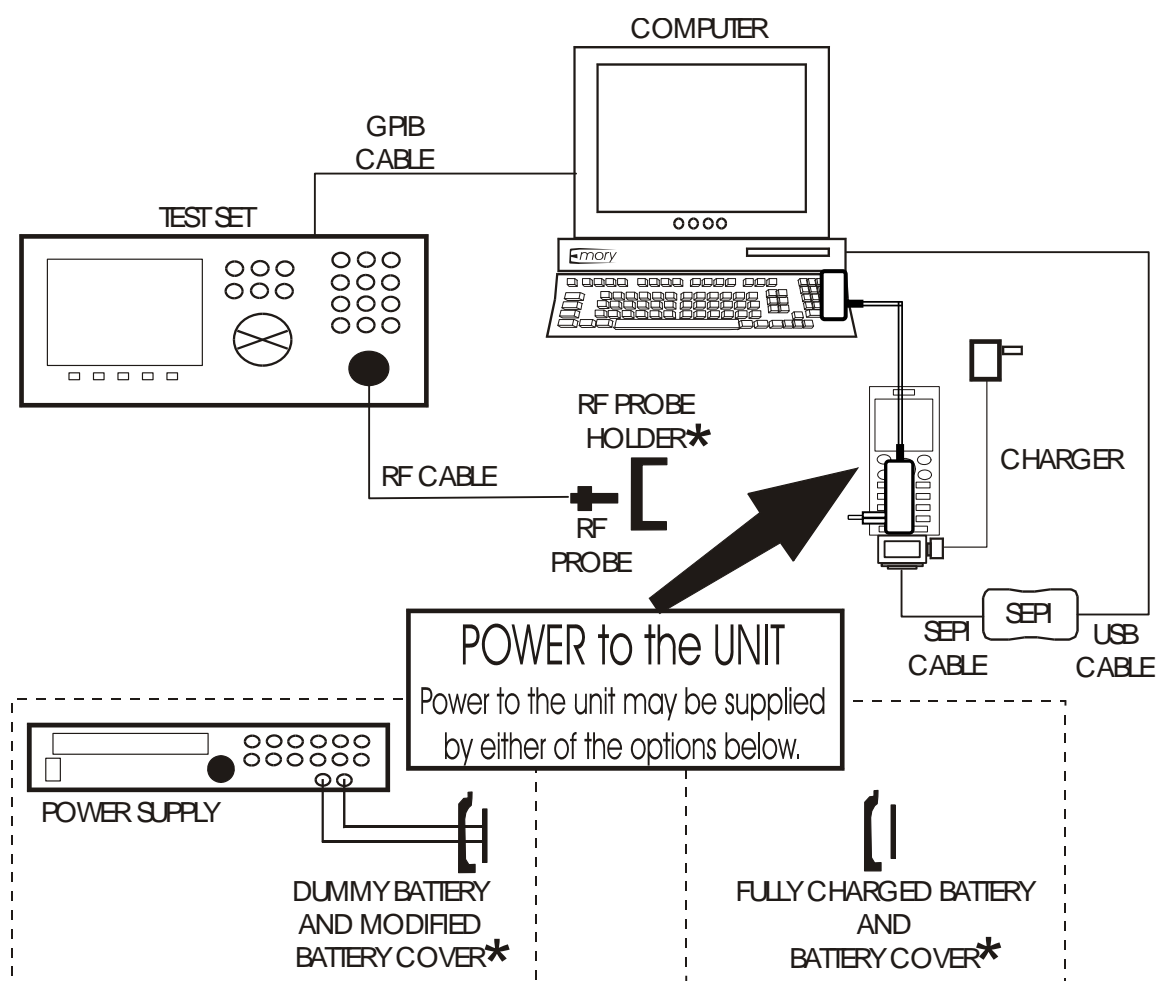

* The RF Probe Holder, Battery Cover, and Modified Battery Cover may not be used for every product. See the Installation Instructions and Test Instructions for details.

3.2 Test Set

A Test Set approved according to the Instrument List must be used. It should be installed according to the Instrument Manufacturer Instructions.



3.3 Power Supply

Power Supply according to Instrument List must be used.

3.4 Battery eliminator

Battery eliminator is to be used together with a power supply to power the phone during the calibration. Connect the cables from the battery eliminator to the power supply, red cable to positive output terminal and black cable to negative output terminal.

3.5 GPIB card and cable

GPIB card and cable according to the Equipment List. Use the GPIB cable to connect the GPIB card to the test instrument.

3.6 RF Connection

RF-holder and RF adapter according to Equipment List. Connect the RF adapter to the RF cable. The RF adapter is held on the phone with the RF fixture.

3.7 Sony Ericsson programming interface – SEPI

The USB programming interface is delivered with the necessary software and instruction for installation. The USB programming interface (SEPI) should be connected to an USB-port on the computer. A standard Sony Ericsson Mobile Communication charger, CST-60 must be connected to the SEPI.

3.8 Sony Ericsson programming interface cable

The cable is the interface between the USB programming interface (SEPI) and the phone.

3.9 USB PC cable

The A-B Plug-Plug cable is the interface between the computer and the USB programming interface (SEPI). Connect the cable between the USB programming interface and the computer.

4 General Equipment

4.1 Test Set up

General Test set up to perform SW loading and manual test according to Test Instruction. All necessary hardware for this test set up is documented in the Electrical Equipment list.

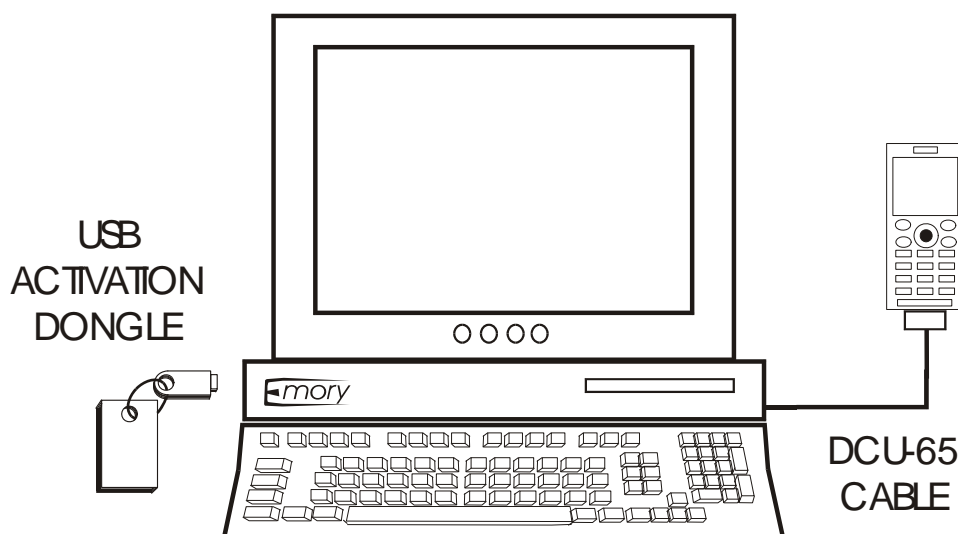

4.2 Computer

IBM compatible computer is required. The computer should include at least two USB-ports. Refer to Equipment List for minimum requirements.

4.3 Service Card Reader and Service Card

The Service Card Reader is delivered with the necessary software and instructions for installation. The Service Card Reader should be connected to an USB-port on the computer.

4.4 Sony Ericsson programming interface – DCU-65

The cable is the interface between the computer and the phone. DCU-65 cable should be connected to an USB-port on the computer.

4.5 Label Printer (optional)

A Zebra printer model 90xi, 90xill or 4000 deluxe shall be used. Connect the printer with a standard RS 232 serial printer cable [refer to the Zebra printer manual] to the serial port on the computer. Read the Zebra installation manual for more information about the installation.

4.6 Bluetooth Device

Any Bluetooth device as headset, other Bluetooth phone or other Bluetooth device can be used to verify the Bluetooth function in the phone. Set up the connection according to the chosen equipments manufacturer.

5 Software

5.1 EMMA

EMMA contains all software required to service the product. Installation and user manuals are available in the EMMA start page.

<http://ma3.extranet.sonyericsson.com/ma3/>

5.2 Labelmake II software (optional)

LabelMake II is an application installed through Java Web Start.

Access the Labelmake software from [CSPN](http://cspn.extranet.sonyericsson.com) Web page.

You will find LabelMake II in the dropdown menu on the CSPN web page.

<http://cspn.extranet.sonyericsson.com>

Press "START LabelMake II "button and you will be directed to the LABELMAKE II client page.

Product labels are downloaded on-line from a remote server database.

5.2.1 Willtek 420x Go/No-Go Test Script

An approved Sony Ericsson Test Script must be installed in the Test Instrument. The Willtek 420x script can be downloaded from CSPN. The Test Script is located on CSPN under **Repair Instructions / Standard**.

The FEA number for the 420x test script is 1213-7931 x when using the R&S Coupler or the RF Fixture.

NOTE! The “x” in the FEA number refers to the revision of the Test Script. Ensure the latest revision script posted to CSPN is installed.

Install the Test Script according to the Instrument Manufacturer’s Instructions.

5.2.2 SERP Go/No Go Test Script

SERP stands for “**S**ony **E**ricsson **R**epair **P**latform”. It is an application used for testing, calibrating and repairing Sony Ericsson mobile phones.

1. Download the latest revision of the SERP application from CSPN (**Repair Instructions/Standard/SERP Install Package**) or through the use of the SERP Online Update Tool (OUT).
2. Unzip the file and open the file “SERP_Installation.doc” for installation instructions.
3. After SERP is installed a file titled “SERPINFO.htm” will be placed on the Windows Desktop. This file contains numerous documents including:
 - SERP Users Manual – This document contains system requirements, release notes, fault reporting instructions, supported test instruments, installation procedures and detailed operating instructions.
 - SERP Troubleshooting Guide – This document contains a few troubleshooting steps that should be reviewed before reporting issues to Sony Ericsson.
 - SERP Trouble Report Form – This form should be filled out when reporting SERP issues to the regional support team.
 - SERP OUT Quick Guide – This document contains system requirements, registration information and general user guidelines for the OUT application.

5.3 SERP (only authorized centers)

Download the latest revision of SERP application from [CSPN](http://cspn.extranet.sonyericsson.com). This application is located under **Repair Instructions/Standard/SERP Install package**

<http://cspn.extranet.sonyericsson.com>

Unzip the file and open the Installation instructions.
Follow the Install instructions to install SERP.

6 Revision History

Rev.	Date	Changes / Comments
1	2008-05-26	1 st release